

The sample cost estimate below is to assist you in developing a cost estimate for your Project. You may reformat and change the content as needed to accommodate each Project's scope. The items listed are illustrative only and are not intended to direct you in determining the scope of your Project, but merely to let you know the level of detail preferred.

**SAMPLE COST ESTIMATE**

**CAPITAL IMPROVEMENTS**

**AMOUNT**

Repair of gutted equipment room	\$27,800.00
Additions to room including masonry, fire sprinklers, HVAC, doors, glass fronts, T-bar ceiling and other miscellaneous	\$90,600.00
Exercise and Dance room features which include mirrors, flat screen TV's, blinds, DVD Player, wood flooring and other miscellaneous items	\$56,200.00
Playground area equipment and flooring	\$45,400.00
	\$
SUBTOTAL	\$220,000.00

**OTHER PROJECT-RELATED COSTS**

**AMOUNT**

Design	\$
Administration	\$
Contingencies	\$
SUBTOTAL	\$0

**GRAND TOTAL \$220,000.00**

**FUNDING SOURCES**

Per Capita	\$220,000.00
_____	\$
_____	\$

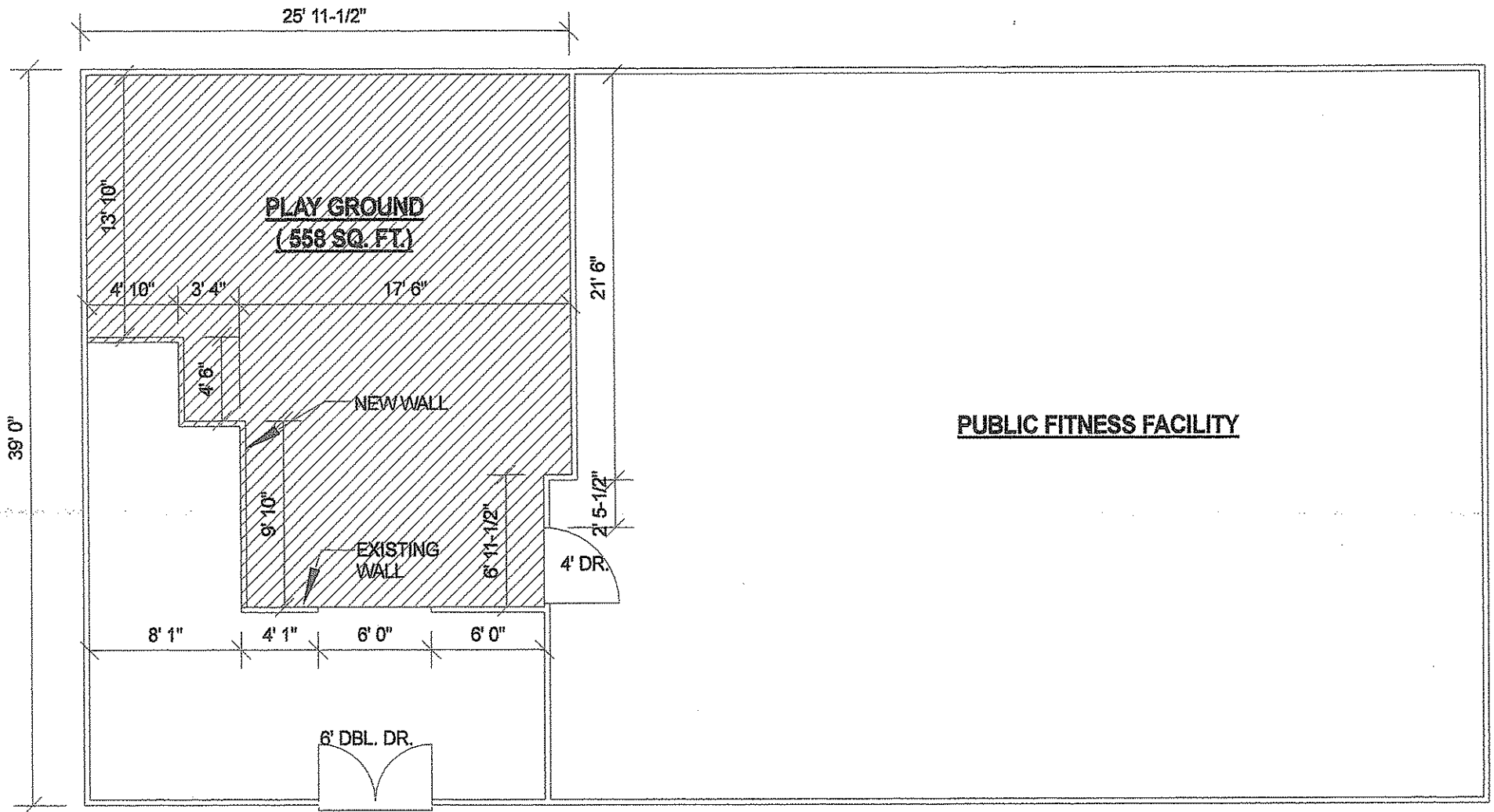

**FLOOR PLAN**

SCALE: 1/8" = 1'- 0"